

NAME:
 ADDRESS:
 PARCEL NUMBER:

CHECKLIST

- SHOW ALL DIMENSIONS BETWEEN STRUCTURES
- SHOW NEW STRUCTURE DIMENSIONS
- SHOW DISTANCES TO PROPERTY LINES
- SHOW PROPANE TANK LOCATIONS
- SHOW DISTANCES FROM WELL TO LEACH FIELDS
- SHOW ADDRESS & PARCEL NUMBER
- SHOW SEPTIC TANK LOCATION & SIZE
- SHOW ALL UTILITY & ACCESS EASEMENTS
- ** ADDITIONAL GRADING INFO MAY BE REQUIRED

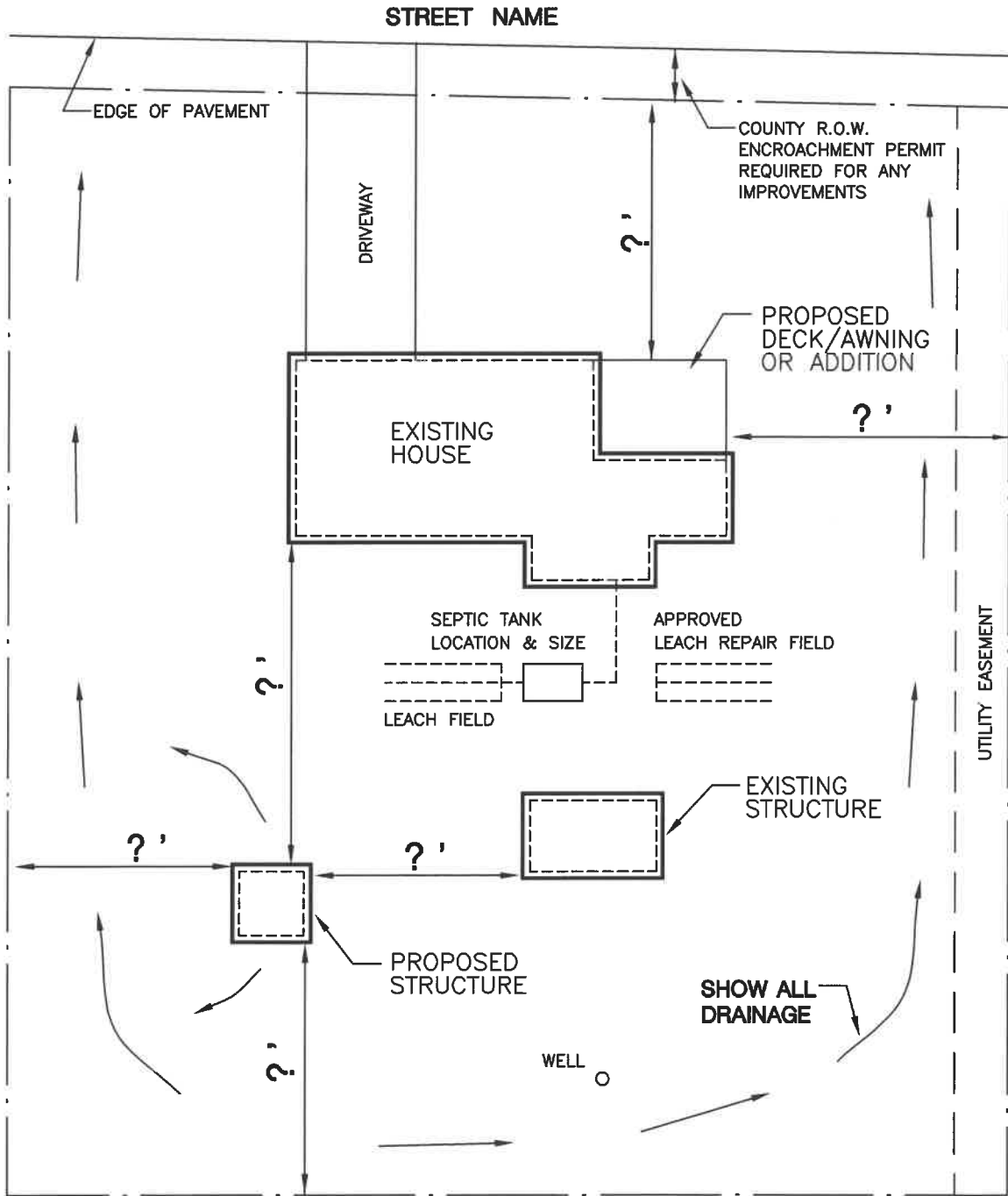

PLOT PLAN EXAMPLE

SCALE (1" = 30'-0" IS RECOMMENDED)

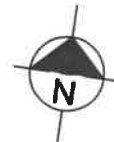

Single Family Residential Patio Covers & Carports

Directions:

1. Fill in the blanks with dimensions and materials which will be used to build the structure. Please print legibly.
2. Indicate in the check boxes which details from page 3 will be used. You must keep at least two sides of the carport open to meet building code requirements.
3. Roofing to be installed per manufacturer's instructions, including low slope application and required inspections.

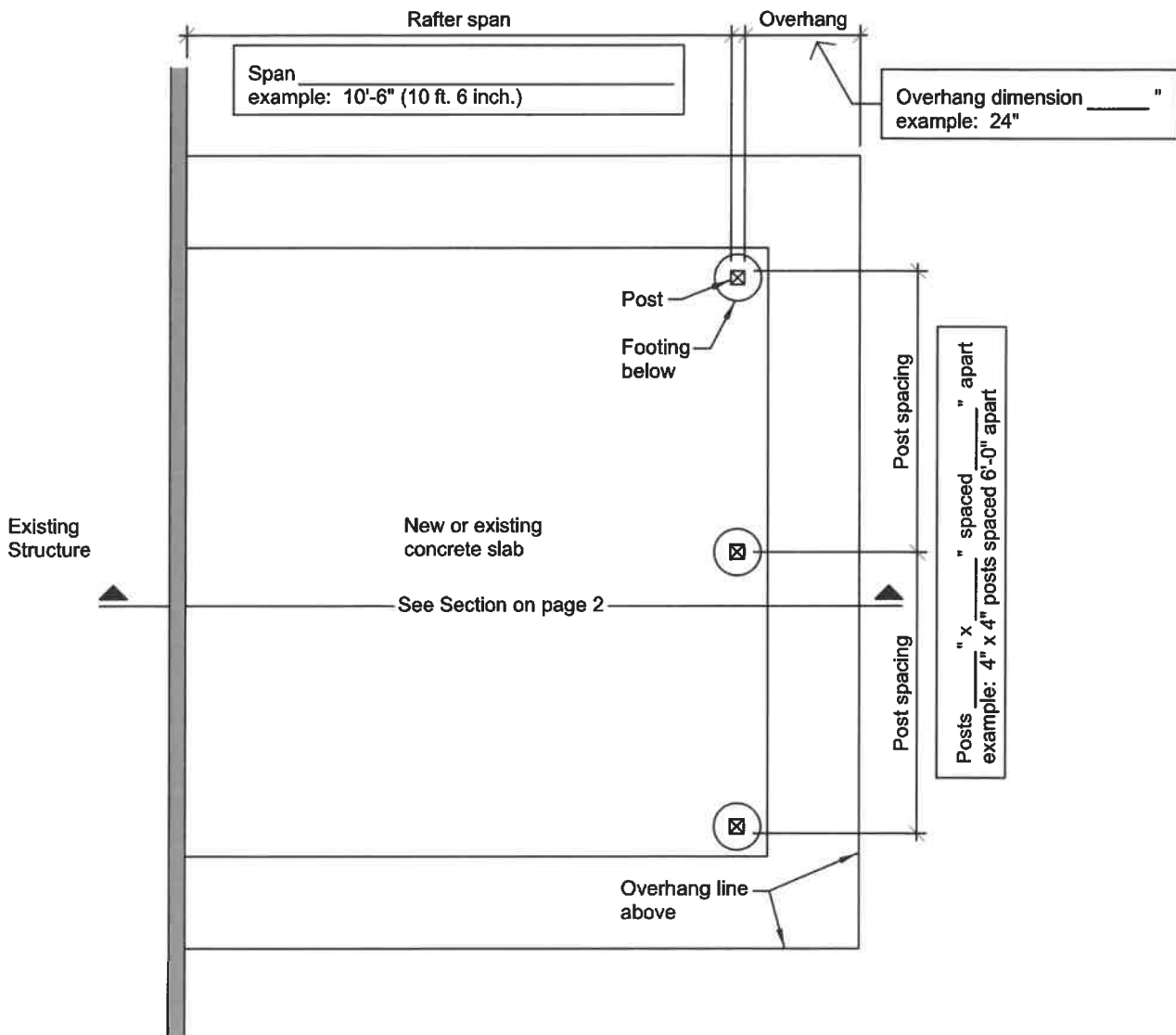

Patio/Carport Plan

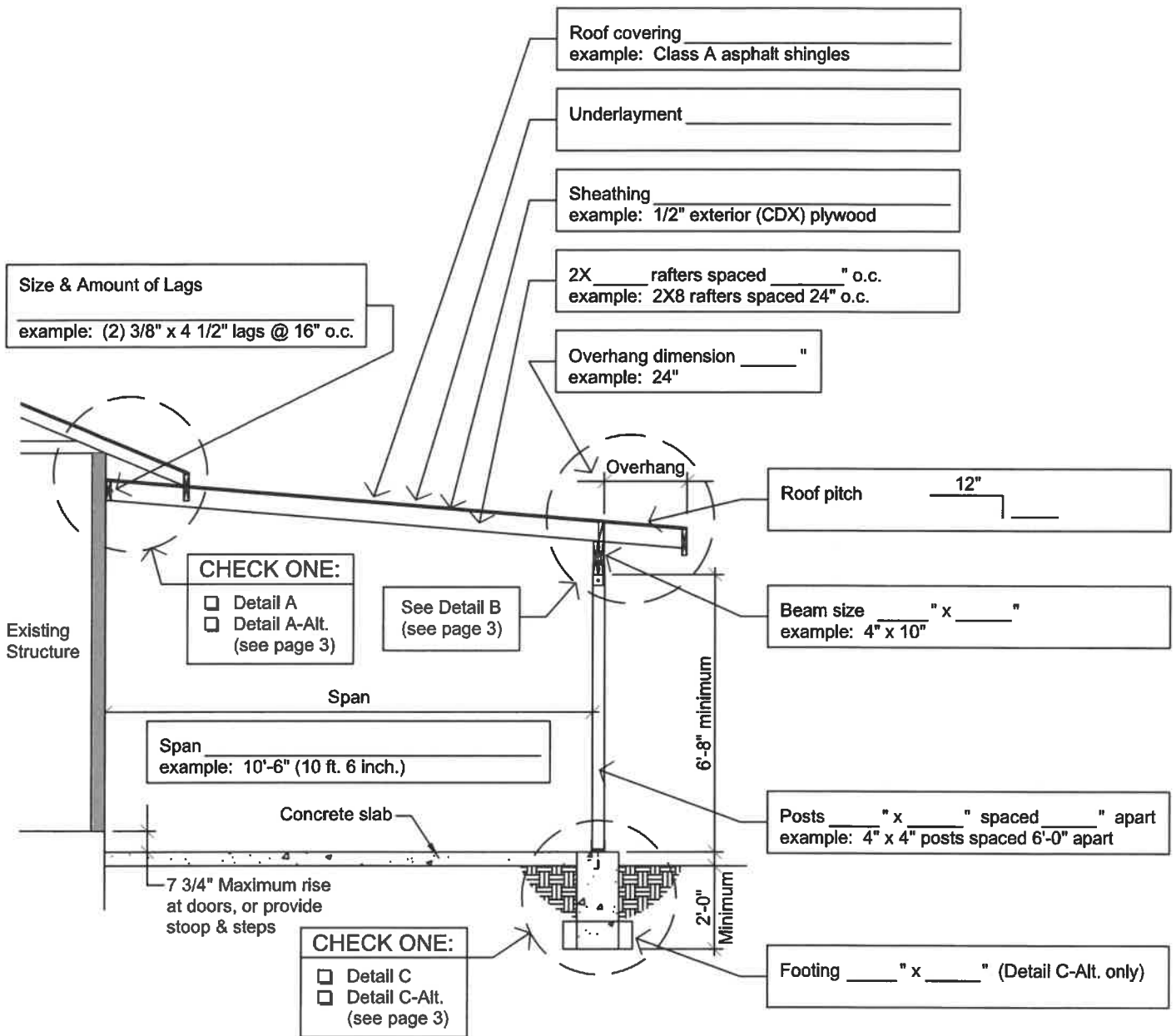

Note:

A patio cover shall be permitted to be supported on a slab on grade without footings, provided the slab is not less than 3.5 inches thick & the columns do not support a live & dead loads in excess of 750 pounds per column.

Patio/Carport Section

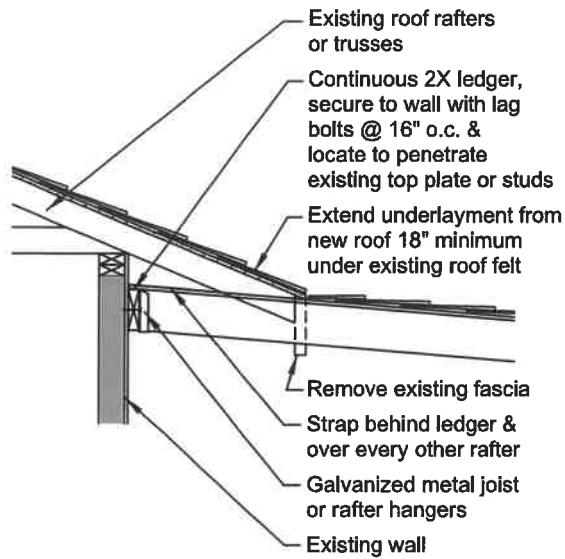

Detail A

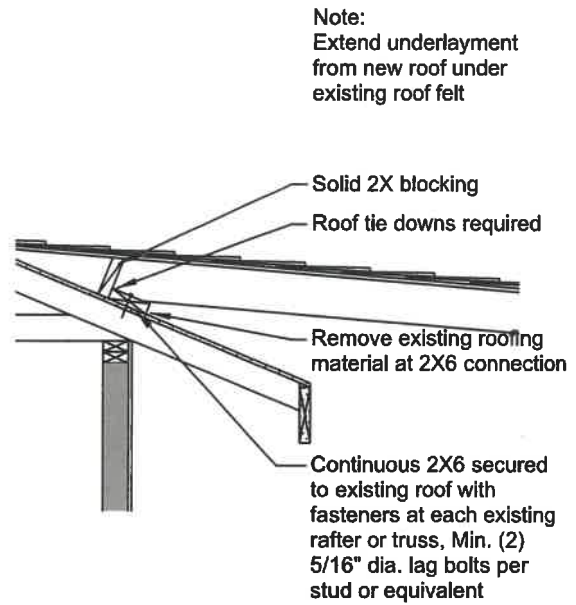

Detail A-Alt.

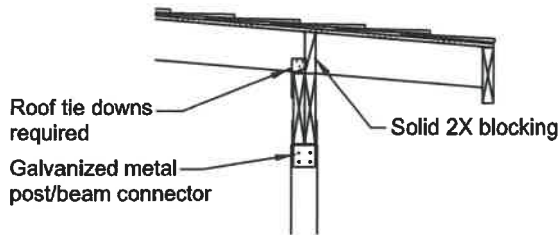

Detail B

Note:
A patio cover shall be permitted to be supported on a slab on grade without footings, provided the slab is not less than 3.5 inches thick & the columns do not support a live & dead loads in excess of 750 pounds per column.

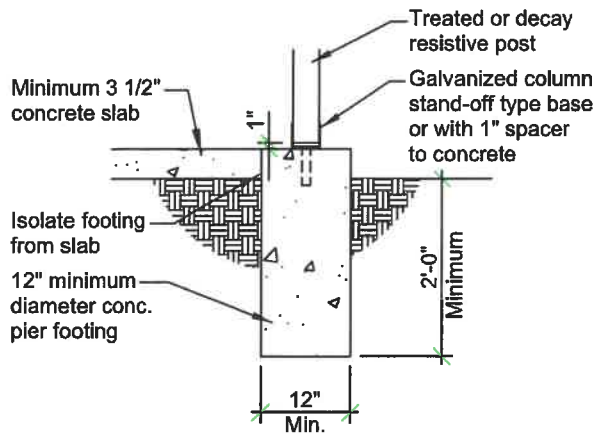

Detail C

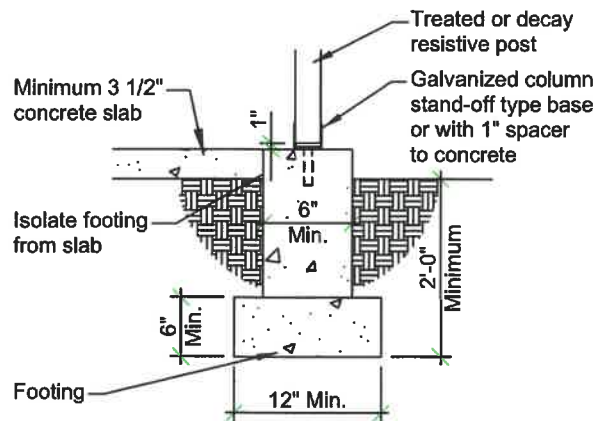

Detail C-Alt.